

This product includes mapping data licensed from Ordnance Survey with the permission of HMSO © Crown Copyright LBH 2021. All rights reserved. License number 100019199.

# PEDESTRIAN and CYCLE ZONE



Mon - Fri  
8:30 - 9:30am  
2:45 - 3:45pm

**Except permit holders SS16**

## NOTES:

- Proposed School Street
- Proposed cycle/ped zone sign & post
- Properties eligible for a school street exemption permit
- Existing double yellow road marking
- Proposed enforcement blips to be introduced on junction corners
- Existing one-way traffic flow
- LC Proposed lamp column for CCTV installation

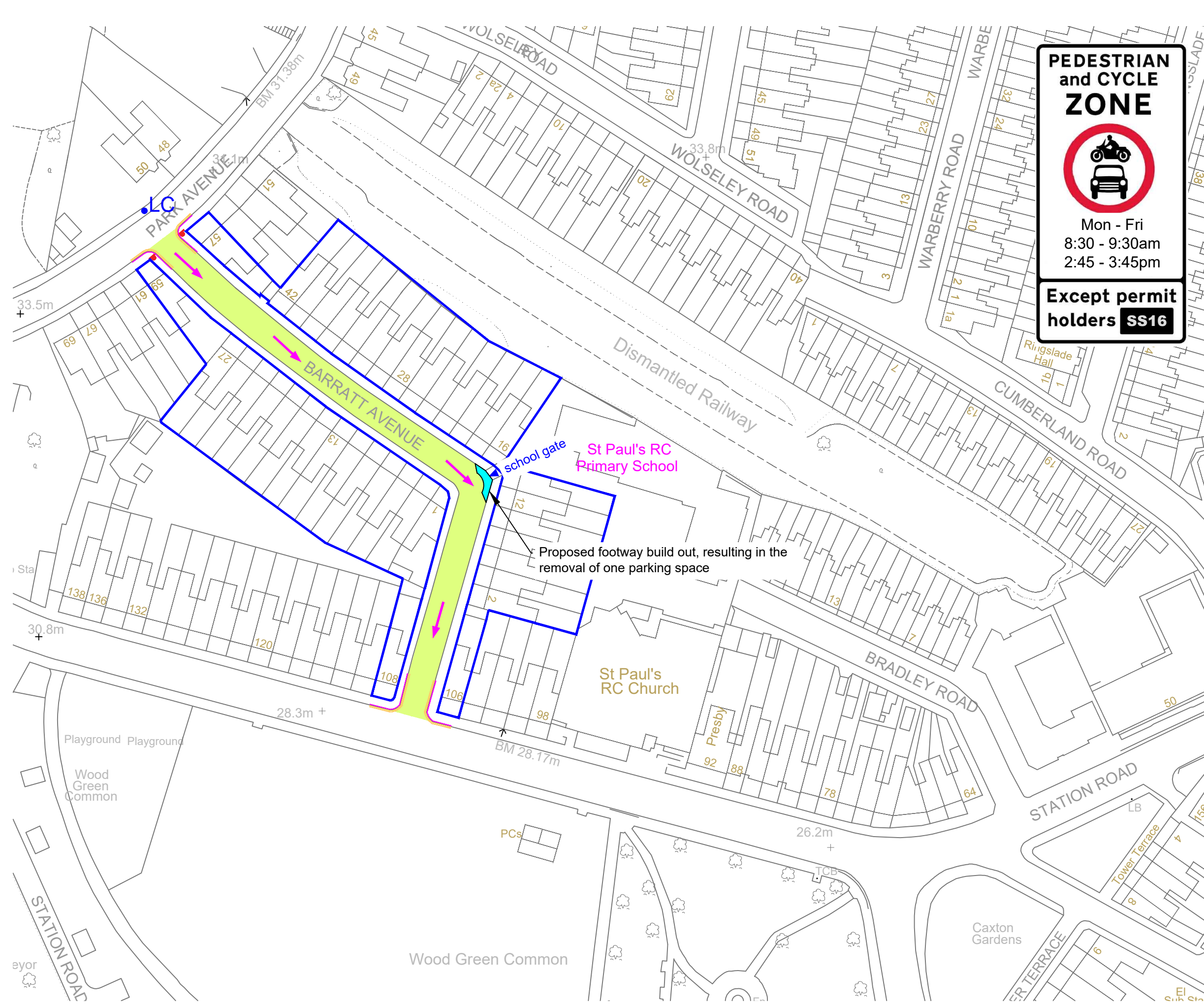
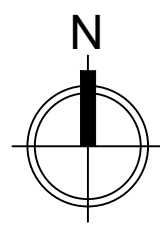

Proposed footway build out, resulting in the removal of one parking space

Rev	Description	Checked	Date
Project: School Street Batch 1			
Title: St Paul's Primary School			
Path: S:\ENSR\Scn\High\Sn\PAIP\Sustainable Transport\TPP Group\.....			
Designed: AH	Drawn: AH	Checked: ##	
Scale: 1:1000 @A3		Date Drawing Created: 21.01.21	
Drg. No: RJHWP-###-ref			Rev: -