

School Street Consultation Devonshire Hill School (SS29)

Dear Resident or Business,

I am writing to you to provide information about a School Street that is proposed in this area and to invite you to share your views as part of this consultation.

What is a School Street?

School Streets transform roads to create a better environment for children to walk, cycle and wheel to school.

How do School Streets help?

When a School Street is in operation, the road temporarily becomes a Pedestrian and Cycle Zone, at school drop-off and pick-up times.

By temporarily closing the road to motor vehicles at the start and end of the school day, School Streets help by:

- Reducing traffic outside the school, which reduces emissions and makes the air around the school cleaner at peak times for children
- Making it safer to walk, cycle, scoot, and wheel to school. Children will benefit from increased physical activity on their journey to and from school
- Reducing traffic congestion and parking problems outside the school and reducing road danger

Residents and businesses can apply for exemptions (details overleaf), giving them the ability to drive into the School Street if needed. Emergency service vehicles have access at all times.

What is being proposed?

The proposal is shown on the enclosed plan and is summarised as follows:

- Weir Hall Road (between Barclay Road and Oak Avenue) proposed to become a School Street that would operate:
 - Term time only
 - Monday to Friday
 - 8:30am – 9:15am and 2:30pm – 3:45pm
- Relocation of parking places from the footway to the carriageway, to improve accessibility
- A raised table at the junction with The Weymarks, to the north of No. 35 Weir Hall Road
- Planting of new street trees on east side of Weir Hall Road
- Motor vehicles (cars, vans, motorcycles etc.) will not be allowed to enter the School Street during the above times unless they had been issued an exemption (see details below)
- To inform drivers, we will install traffic signs and send updates to sat-nav companies
- Motor vehicles that enter the School Street without an exemption, during operational hours, will be identified by camera and may be issued a Penalty Charge Notice (PCN)
- No one needs an exemption to drive out of a School Street. You only need an exemption to drive into the School Street during operational hours
- School Streets remain open to people walking, cycling and wheeling
- Emergency services will always have unhindered access

Who is eligible for a School Street exemption?

If the scheme goes ahead, the following groups would be eligible to apply for an exemption:

- Residents or businesses who have an address within the School Street (see note below) to a maximum of two per property
- Blue Badge holders who require access to the School Street

- Pupils with a disability that prevents them walking or cycling to school
- Medical practitioners visiting someone with an address in the School Street
- School vehicles transporting disabled children

Note: properties within the boundary of the School Street would be eligible for a resident or business School Street exemption. Those properties are outlined in blue on the enclosed plan.

Motor vehicles without an exemption, including visitors, tradespeople or delivery drivers are not permitted to drive into the School Street during operational times. But no exemption is required to drive out of a School Street, eg. those vehicles that were already parked when it came into operation.

Why is the Council considering a School Street?

These proposals are part of Haringey's plan to improve air quality, children's health, tackle the climate emergency and to make it safer and easier for children to walk and cycle. The council has been working with schools across the borough and has delivered 23 School Streets to date.

The proposals are also intended to minimise displaced traffic, during school start and end times, from a Bus Gate that is proposed for Bull Lane by London Borough of Enfield.

How can I have my say?

We welcome your views on the enclosed proposals. Please respond to the consultation before Monday 12 December 2022. The easiest way to give feedback is by [completing a short online questionnaire](#) or by scanning this QR code.



If you need assistance responding, you can email schoolstreets@haringey.gov.uk or call 020 8489 4787.

In addition, we will shortly be advertising the proposed traffic orders for this scheme and carrying out statutory consultation. Further details of the process will be given on the public notice with opportunity for any person to object.

What happens next?

We continue to work jointly with the London Borough of Enfield on this scheme.

Once the consultation has closed, we will review all feedback received and take a decision on how to proceed. This decision is expected in January 2023. If the School Street is approved, we expect to implement the School Street in the February or March, subject to statutory (traffic order) consultation.

Before any School Street launches, we will write to all eligible properties explaining how to apply for an exemption.

More information

For more information on our School Street programme, please visit www.haringey.gov.uk/school-streets

Yours faithfully,

Haringey School Street Team

Alternative formats and translations

If you would like the document translated or in an alternative format (including audio) please contact us with your name, address and title of the document you need assistance with:

Email: consultationtranslation@haringey.gov.uk

Write to: Freepost Plus RTKX-AJJC-ULRY London Borough of Haringey N22 8HQ

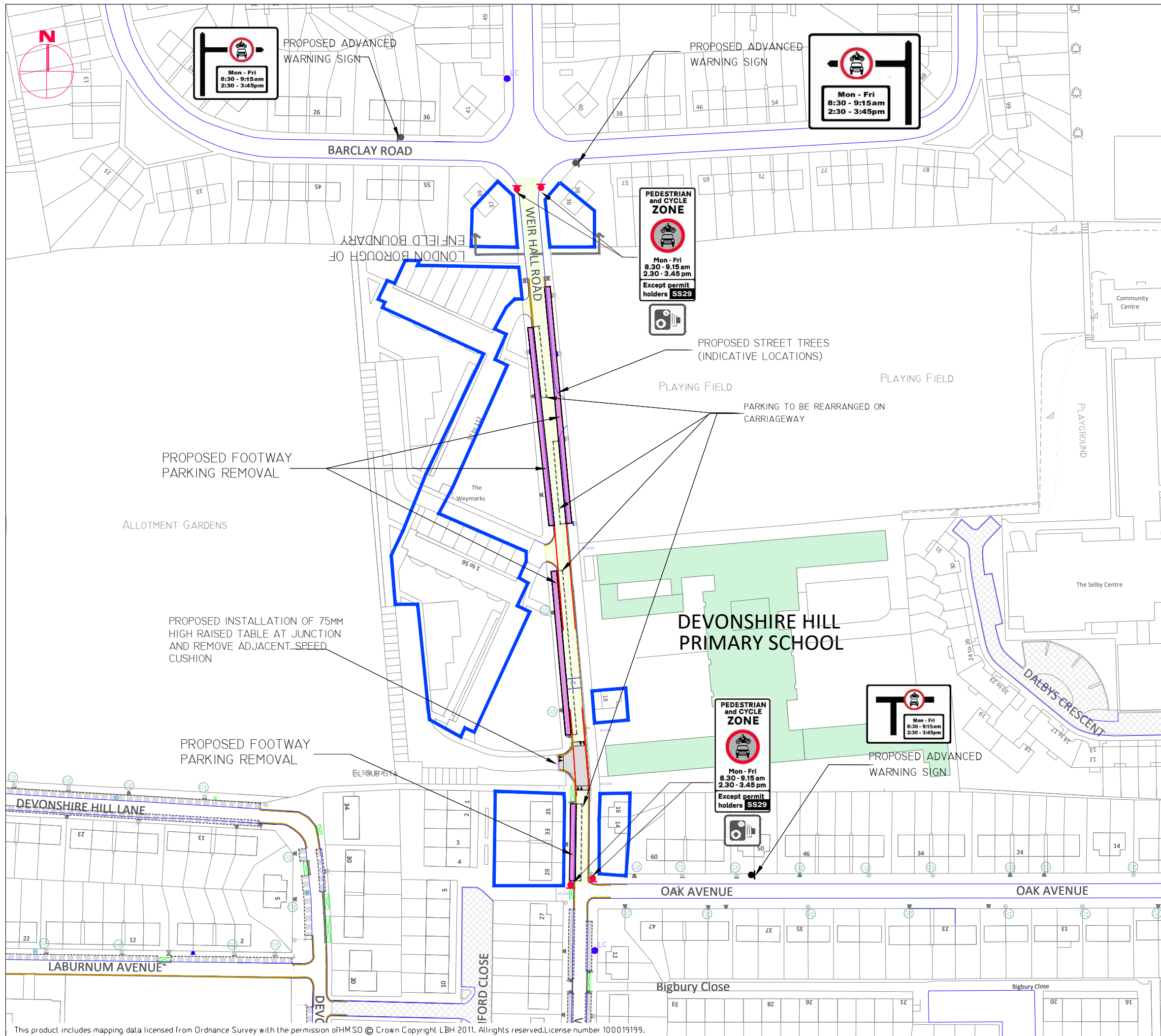

KEY

- PROPOSED SCHOOL STREET
- PROPOSED FOOTWAY PARKING REMOVAL
- PROPOSED CYCLE/PED ZONE SIGN & POST
- PROPERTIES ELIGIBLE FOR A SCHOOL STREET EXEMPTION PERMIT
- PROPOSED REMOVAL OF SCHOOL KEEP CLEAR (SINGLE YELLOW LINE TO BE CONVERTED TO DOUBLE YELLOW)
- EXISTING DOUBLE YELLOW ROAD MARKING
- LC PROPOSED LAMP COLUMN FOR CCTV INSTALLATION

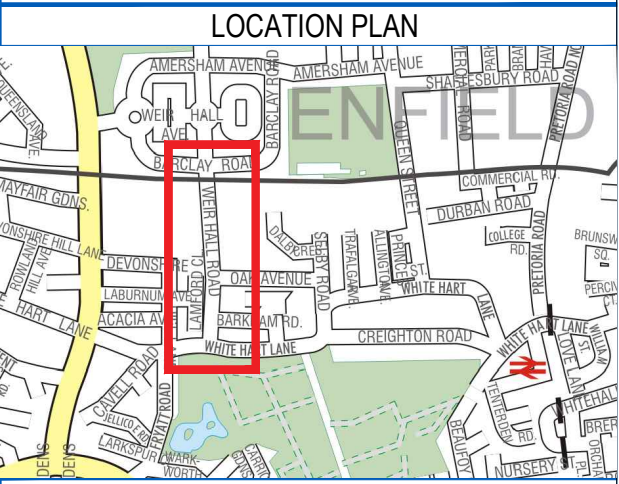

Project name:
SCHOOL STREETS

Drawing name:
DEVONSHIRE HILL PRIMARY SCHOOL

Notes:
CONSULTATION PLAN

SCALE:
1 : Scale @ A3

DRAWN:	CHECK:	DATE DRAWN:
--------	--------	-------------

Drawing No. **Haringey LONDON**

This product includes mapping data licensed from Ordnance Survey with the permission of HMSO © Crown Copyright LBH 2011. Allrights reserved.License number 100019199.