





This product includes mapping data licensed from Ordnance Survey with the permission of HMSO © Crown Copyright LBH 2021. All rights reserved. License number 100019199.

**NOTES:**

-  Proposed School Street
-  Proposed cycle/ped zone sign & post
-  Existing double yellow road marking
-  Proposed enforcement blips to be introduced on junction corners
-  LC Proposed lamp column for CCTV installation

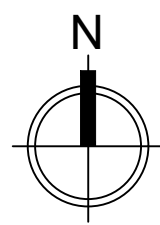

Rev	Description	Checked	Date
Project: School Street Batch 1			
Title: Harris Academy Primary Tottenham			
Path: S:\ENSR\Scr\High\Sn\FAIP\Sustainable Transport\TPP Group\			
Designed: AH	Drawn: AH	Checked: ##	
Scale: 1:2000 & 1:500 @A3		Date Drawing Created: 21.01.21	
Drg. No: RJHWP-###-ref			Rev: -

**ENVIRONMENT & NEIGHBOURHOODS**  
 5th Floor, Alexandra House, 10 Station Road, Wood Green, London N22 7TR  
 Tel: 020 8489 0000 Fax: 020 8489 1251  
 Director Place and Sustainability: Lyn Garner  

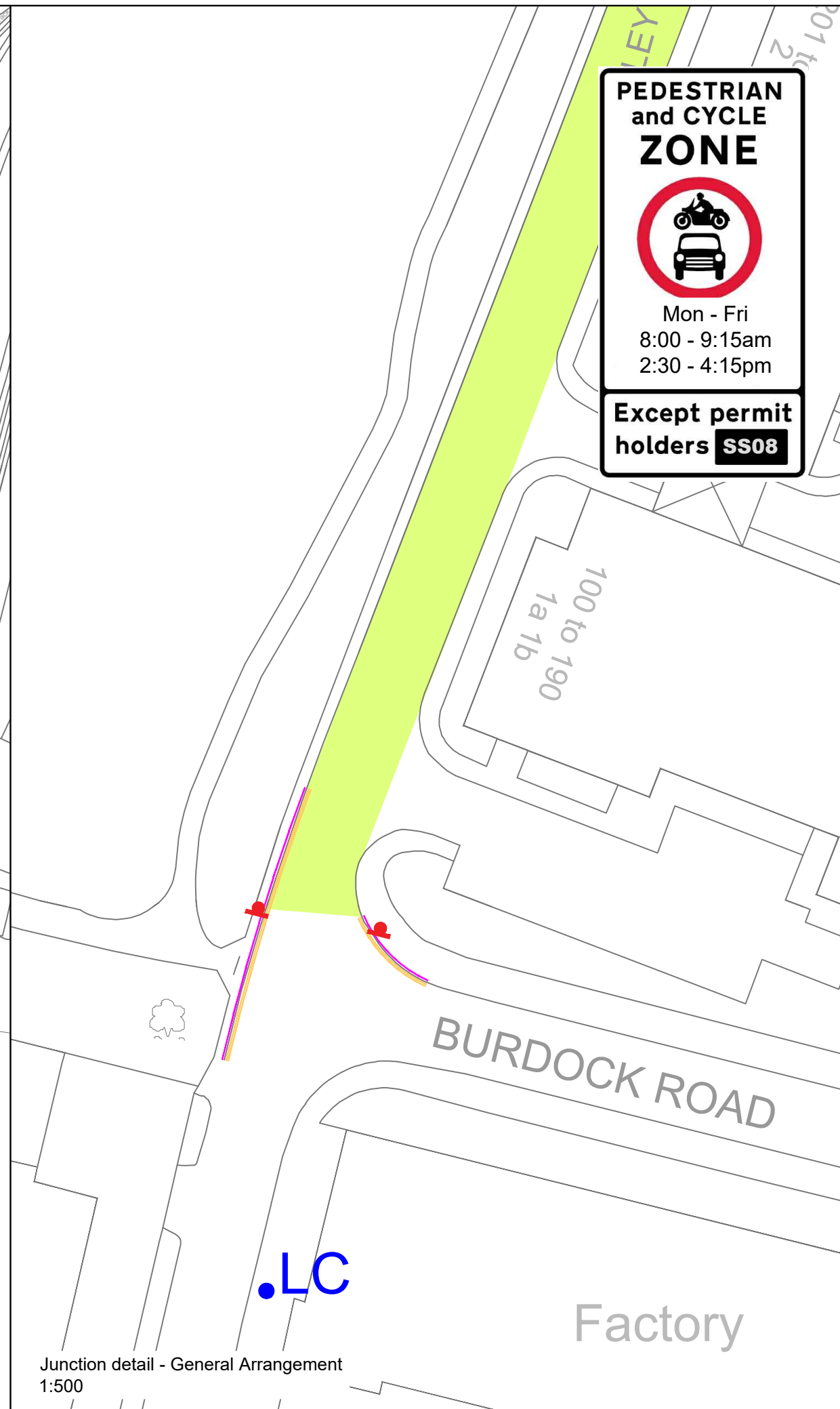
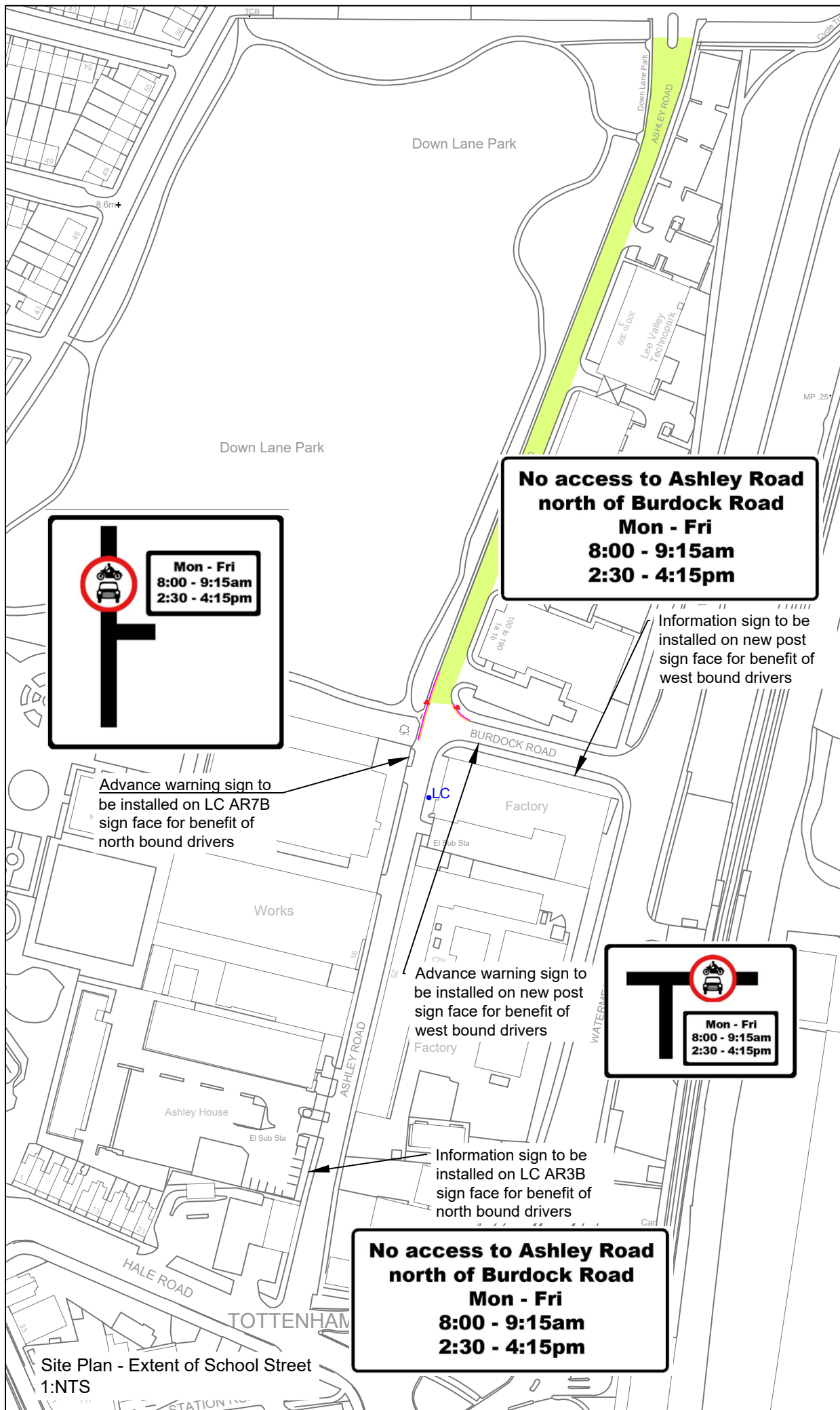
Junction detail - General Arrangement  
1:500

Site Plan - Extent of School Street  
1:NTS