

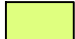





This product includes mapping data licensed from Ordnance Survey with the permission of HMSO © Crown Copyright LBH 2011. All rights reserved. License number 100019199.

**NOTES:**

-  Proposed School Street
-  Existing one-way traffic flow
-  Existing off-street car park
-  Properties school keep clear
-  Existing double yellow road marking
-  Proposed enforcement blips to be introduced on junction corners
-  Proposed diag.619 sign & post

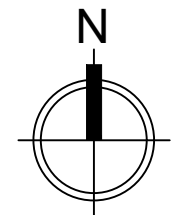

Rev	Description	Checked	Date

Project: **School Street Batch 1**

Title: **Holy Trinity School**

Path: S:\ENR\Scr\High\Sn\FAIP\Sustainable Transport\TPP Group\.....  
.....

Designed: <b>AH</b>	Drawn: <b>AH</b>	Checked: <b>##</b>
---------------------	------------------	--------------------

Scale: <b>NTS @A3</b>	Date Drawing Created: <b>10.06.2020</b>
-----------------------	---

Dwg. No: <b>RJHWP-###-ref</b>	Rev: <b>-</b>
-------------------------------	---------------

**PLACE & SUSTAINABILITY**

5th Floor, Alexandra House, 10 Station Road, Wood Green, London N22 7TR  
Tel: 020 8489 0000 Fax: 020 8489 1251

Director Place and Sustainability: Lyn Garner

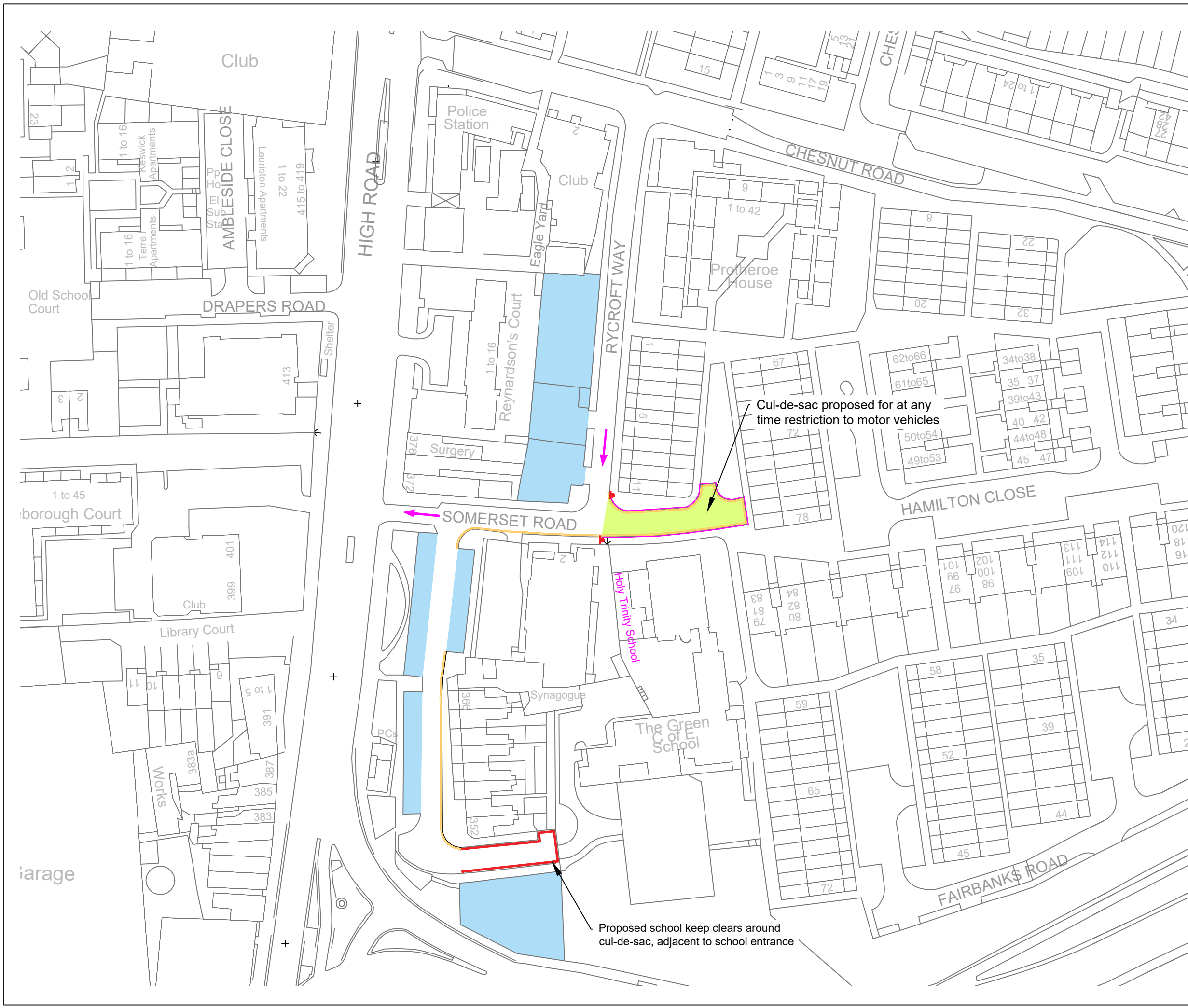

Cul-de-sac proposed for at any time restriction to motor vehicles

Proposed school keep clears around cul-de-sac, adjacent to school entrance