



#

12 October 2011

Works Notice

Improvement works for pedestrians: Ewart Grove junction with High Road N22

Dear Resident or Trader,

Further to our notification letter of 1 September 2011, I write to inform you that the Council has decided to proceed with the implementation of the raised entry treatment at Ewart Grove at its junction with the High Road N22.

The necessary work to put the measures in place are planned to start week commencing 19 October and will take approximately 2 weeks to complete.

Full details are set out on the plan overleaf.

The road will be temporarily closed while the works are in progress. The parking bays closest to the junction will be temporarily suspended so that vehicles can turn around.

Should you require any further information on the works please contact Project Engineer Paul Miles on 0208 489 1717 or email Frontline.consultation@haringey.gov.uk

Thank you for your attention.

Yours faithfully,

Joan Hancox
Head of Sustainable Transport

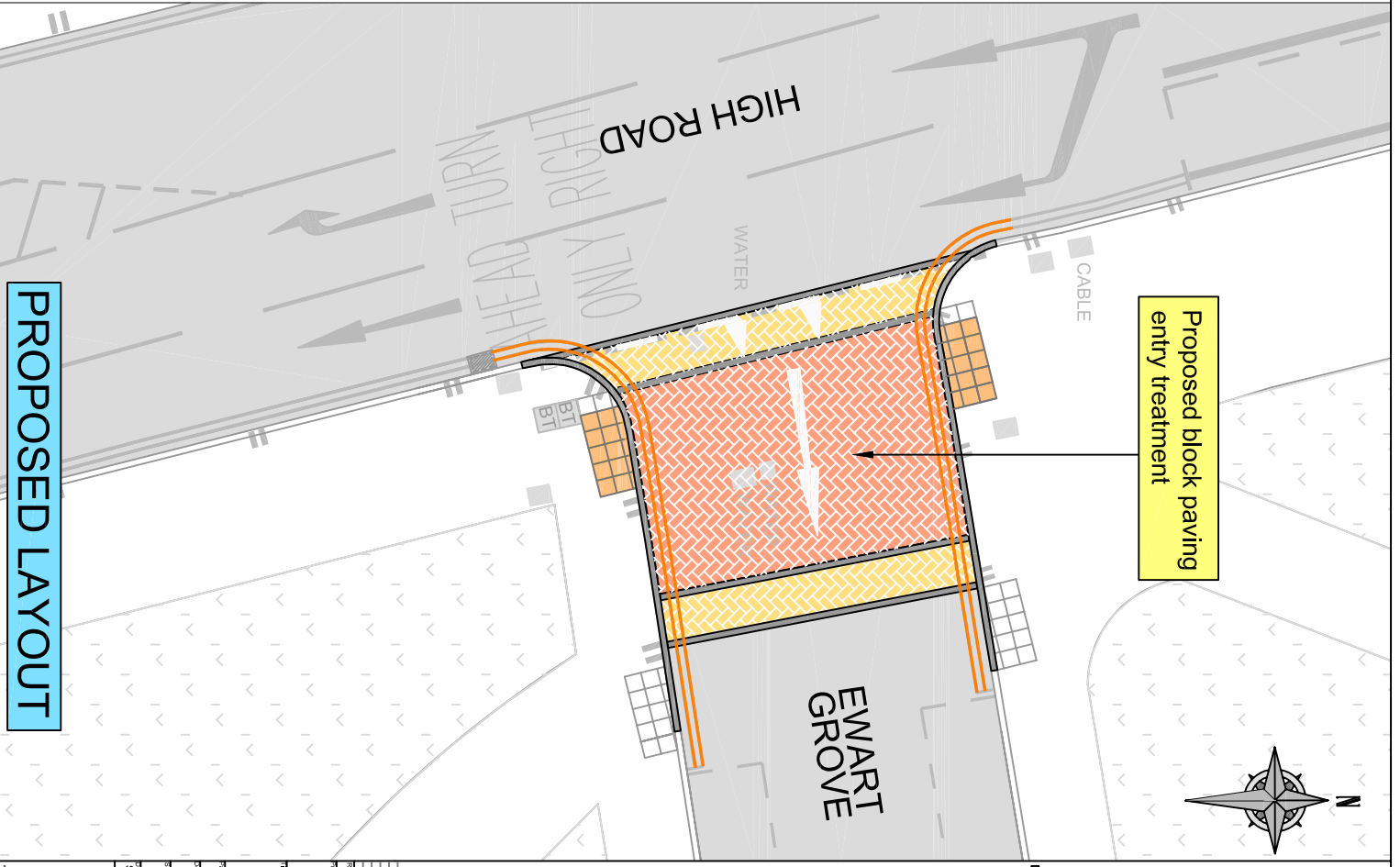
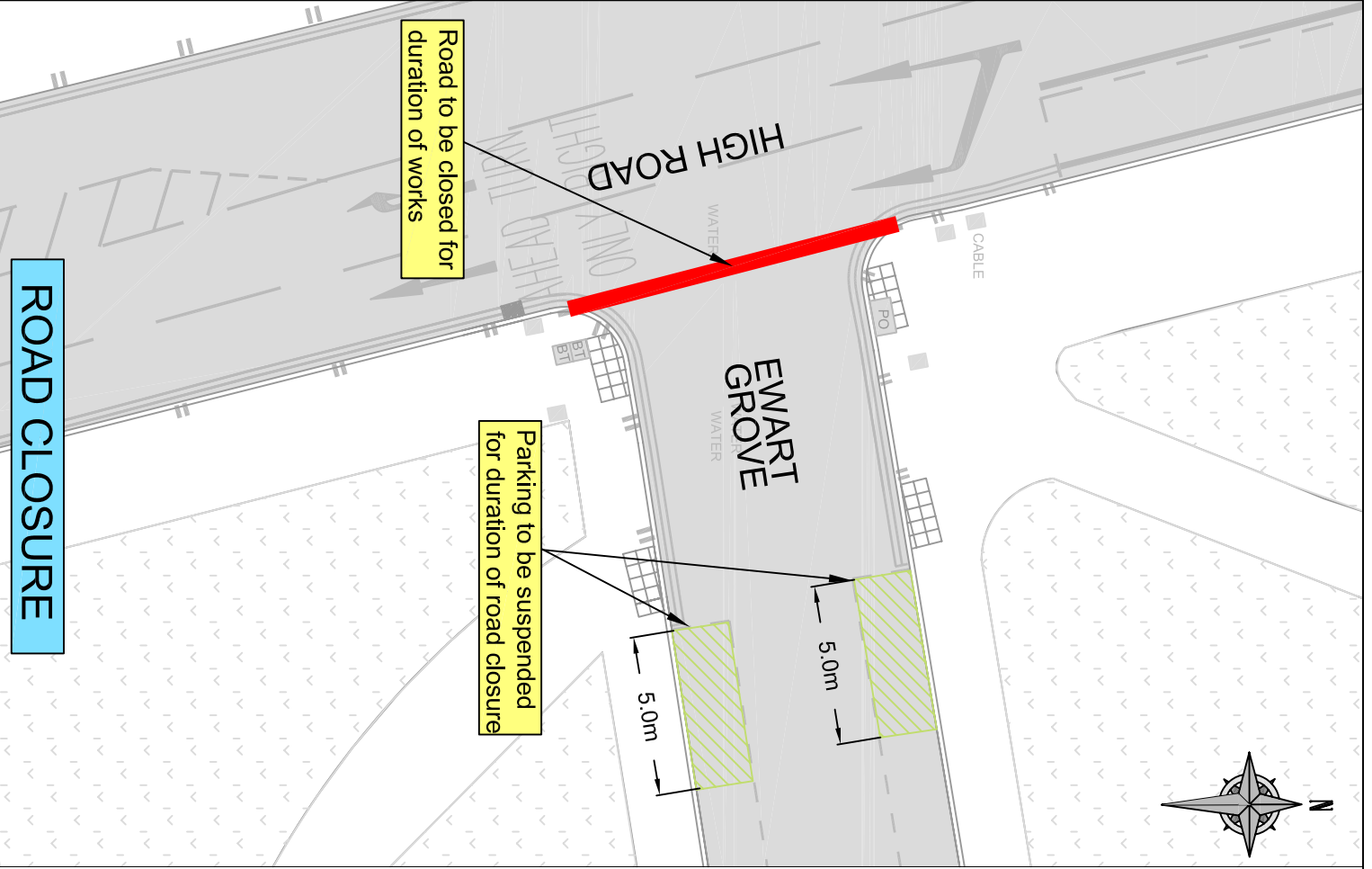

This product includes mapping data licensed from Ordnance Survey. All rights reserved. HMSO © Crown Copyright LBH 2011. All rights reserved. License number: 100019193.

NOTES:

1. All road markings to be renewed to match existing.
2. Road to be closed for a duration of 2 weeks

KEY

- Proposed Granite Kerbs
- Proposed 'buff' coloured Ramped block paving
- Proposed 'red' coloured Raised block paving
- Relaid Tactile Paving

Project	Corridor Wood Green High Road		
Client	Proposed Block Entry Treatment at Eward Grove at Junction with High Road		
Drawn	PM	PM	Checked
Scale	NTS	Date	02/08/2011
Ref	SS-411-10178-EWARD GROVE-2011-1-01		
<p>PLACE & SUSTAINABILITY TRANSPORTSOLUTIONS & PRODUCTS</p> <p>24th Floor, 24th Street, 20th Floor, 20th Street, London, UK</p> <p>020 7494 2000</p>			