



#

01-09-2011

Statutory Notification: Ewart Grove, N22

Dear Resident or Trader,

Improvements for Pedestrians at Ewart Grove at Junction with High Road, N22.

I am pleased to inform you that the Council has secured funding from Transport for London as part of the continuation of the Wood Green Corridor scheme for pedestrian accessibility and safety improvements on Ewart Grove at the junction with High Road N22.

We intend to construct a raised entry treatment on Ewart Grove at its junction with the High Road which will involve raising the road so that it is level with the pavement. The raised entry treatment will improve pedestrian accessibility by creating a convenient level crossing and will also reduce the speed of vehicular traffic and increase their awareness to pedestrians.

Full details are set out in the plan overleaf. This notification letter marks the start of a four week statutory notification period during which we welcome comments and representations by email to Frontline.consultation@haringey.gov.uk. Alternatively you can call our Project Engineer Paul Miles on 0208 489 1717 or you can write to us at the address above. Please ensure that your comments reach us no later than the 30th of September 2011.

If no major objections are received, we plan to start the work on the 10th of October 2011 and expect it will be completed within 2 weeks-weather permitting. We will make every effort to minimise inconvenience while the work is in progress.

The road will be temporarily closed for the duration of the works and five metres of parking bays closest to the junction will be temporarily suspended allowing for vehicles to turn around.

Yours faithfully,

Joan Hancox
Head of Sustainable Transport

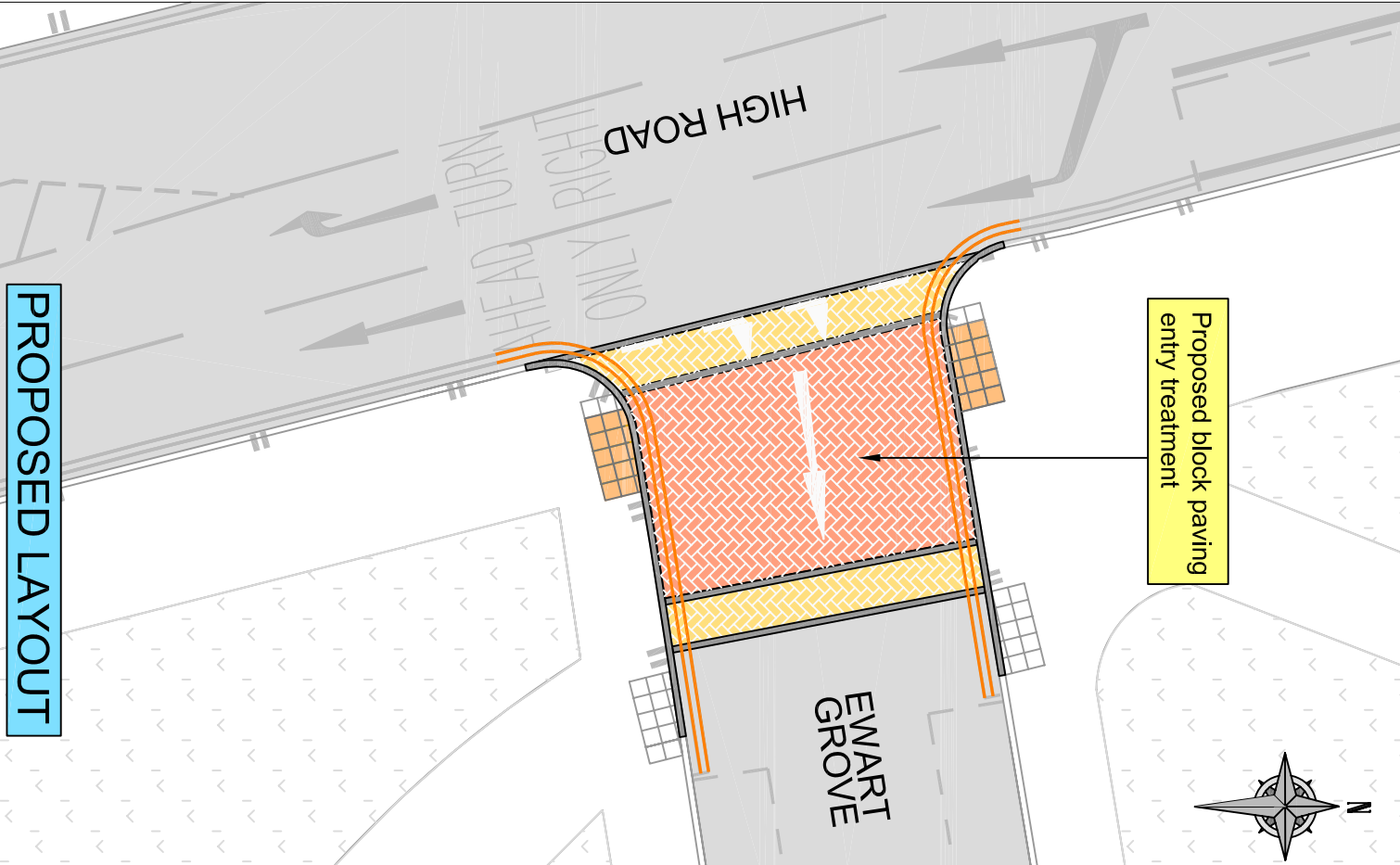
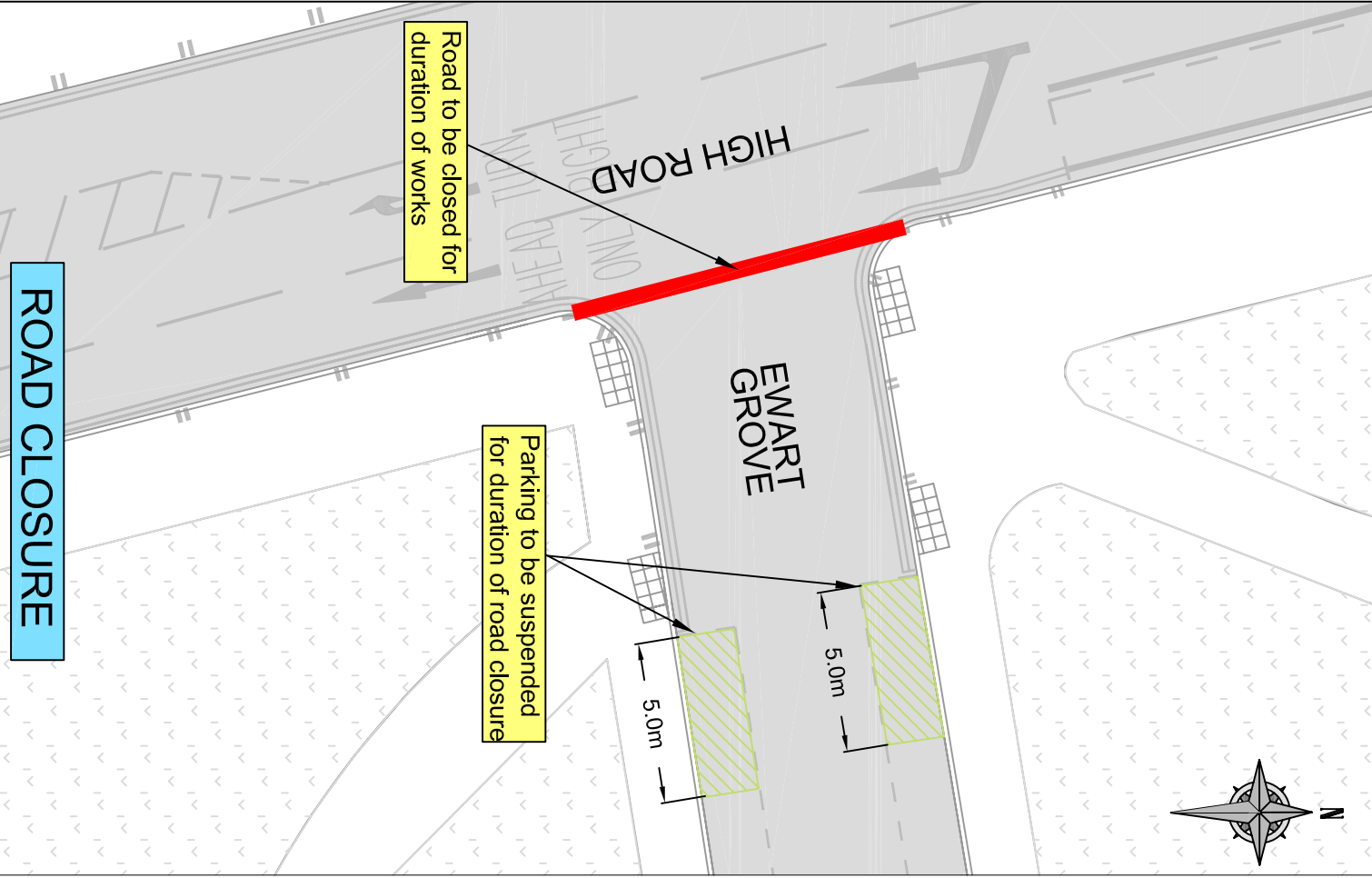

This product includes mapping data licensed from Ordnance Survey with the permission of Ordnance Survey. Copyright LSH 2011. All rights reserved.
License number: 100019199.

- NOTES:**
1. All road markings to be renewed to match existing.
 2. Road to be closed for a duration of 2 weeks

KEY

- Proposed Granite Kerbs
- Proposed 'buff' coloured Ramped block paving
- Proposed 'red' coloured Raised block paving
- Relaid Tactile Paving

Ref	Description	Checked	Date

Corridor
Wood Green High Road

Proposed Block Entry Treatment at Ewart Grove at junction with High Road

PROJECT	SS-H1-0178-EWART GROVE-2011-01
DATE	02/09/2011
SCALE	DATE DRAWN 02/09/2011
DESIGNED BY	PM
CHECKED BY	PM
PROJECT NO.	NTS

FRONTLINE SERVICES
HIGHWAYS ASSET GROUP

2nd Floor, 100, The Quadrant, 2015, Wood Green, London, N22 5BQ
Mobile: 0203 200 2000 Fax: 0203 200 2001 Email: info@fls.co.uk

