



APPENDIX K –
PROPOSED STOPPING UP
ORDER PLAN

APPENDIX K

1. THIS DRAWING IS TO BE READ IN CONJUNCTION WITH ALL RELEVANT PROJECT'S AND ENGINEER'S DRAWINGS AND THE SPECIFICATION.
 2. DO NOT SCALE FROM THIS DRAWING.
 3. THE CONTENT OF STOPPING-UP SHOWN ON THIS DRAWING IS BASED ON SOME ASSUMPTIONS ABOUT THE CURRENT STATE OF ADJACENT HIGHWAY. WE HAVE NOT CONDUCTED VISUAL SURVEYS OF THE LOCAL HIGHWAY AUTHORITY. THERE MAY CHANGE SOME OF OUR CONCLUSIONS.
 4. REF:

AREA TO BE STOPPED-UP
 AREA TO BE STOPPED-UP

FRAMING APPLICATION RED LINE BOUNDARY.
 FRAMING APPLICATION RED LINE BOUNDARY.

| | | | |
|---|----------|--|----|
| C | 10.09.16 | ISSUED FOR INFORMATION (MENSURERS ADD) | DO |
| B | 04.12.15 | ISSUED FOR INFORMATION | AO |
| A | 10.11.15 | ISSUED FOR INFORMATION | AO |
| - | 19.10.15 | ISSUED FOR INFORMATION | AO |

WARDS CORNER REGENERATION

STOPPING UP ORDER PLAN.

DATE: SMa
 DRAWN BY: AO
 CHECKED BY: J.L.
 DATE: OCT 2015
 AS SHOWN

Alan Baxter
 75 Governors Street London ECHM REL
 TEL 020 7250 1555
 email alab@alanbaxter.co.uk
 www.alanbaxter.co.uk

Fig. No. **141117001**
 Rev. **C**

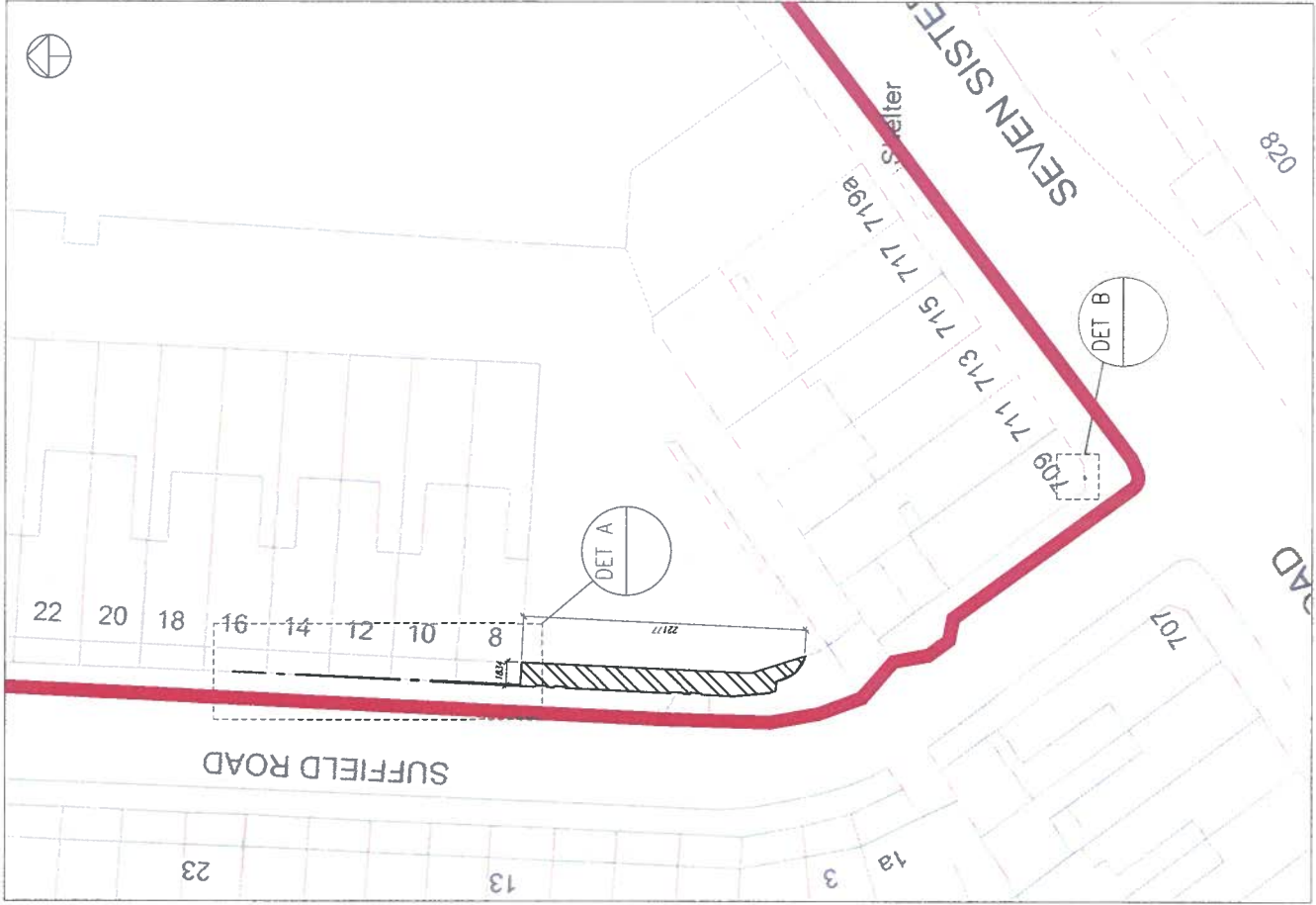

PLAN (1:200)

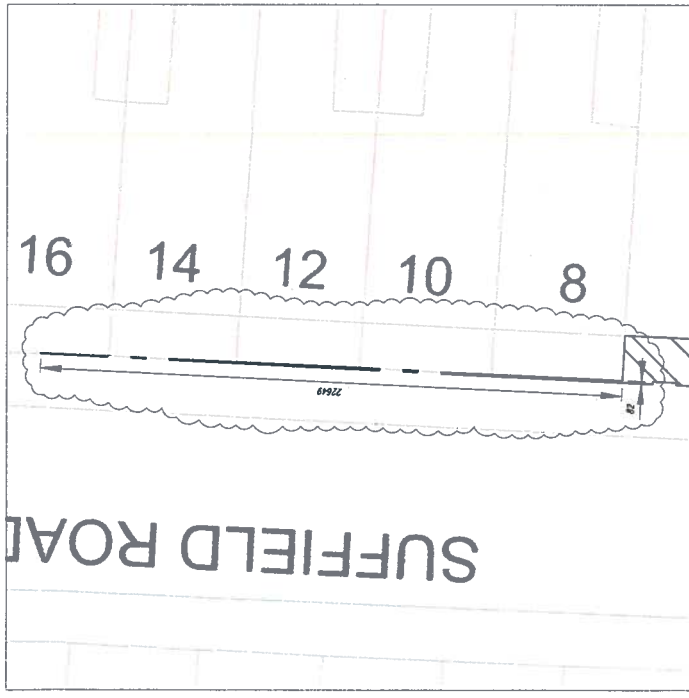

DETAIL A (1:100)

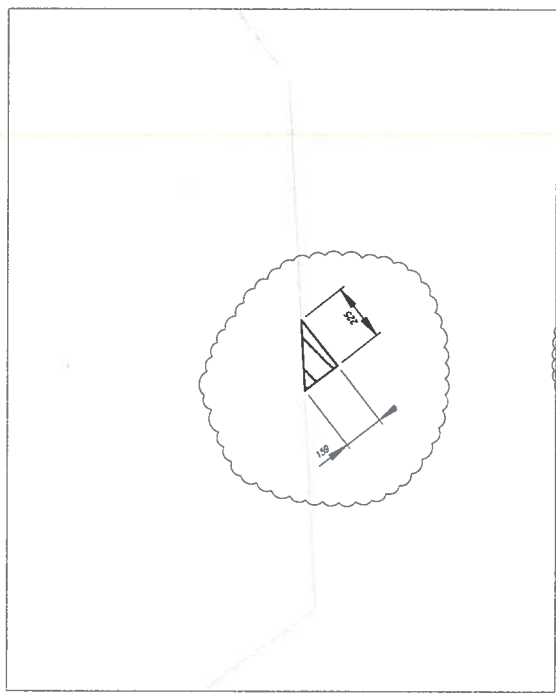

DETAIL B (1:10)