

Wightman road closure

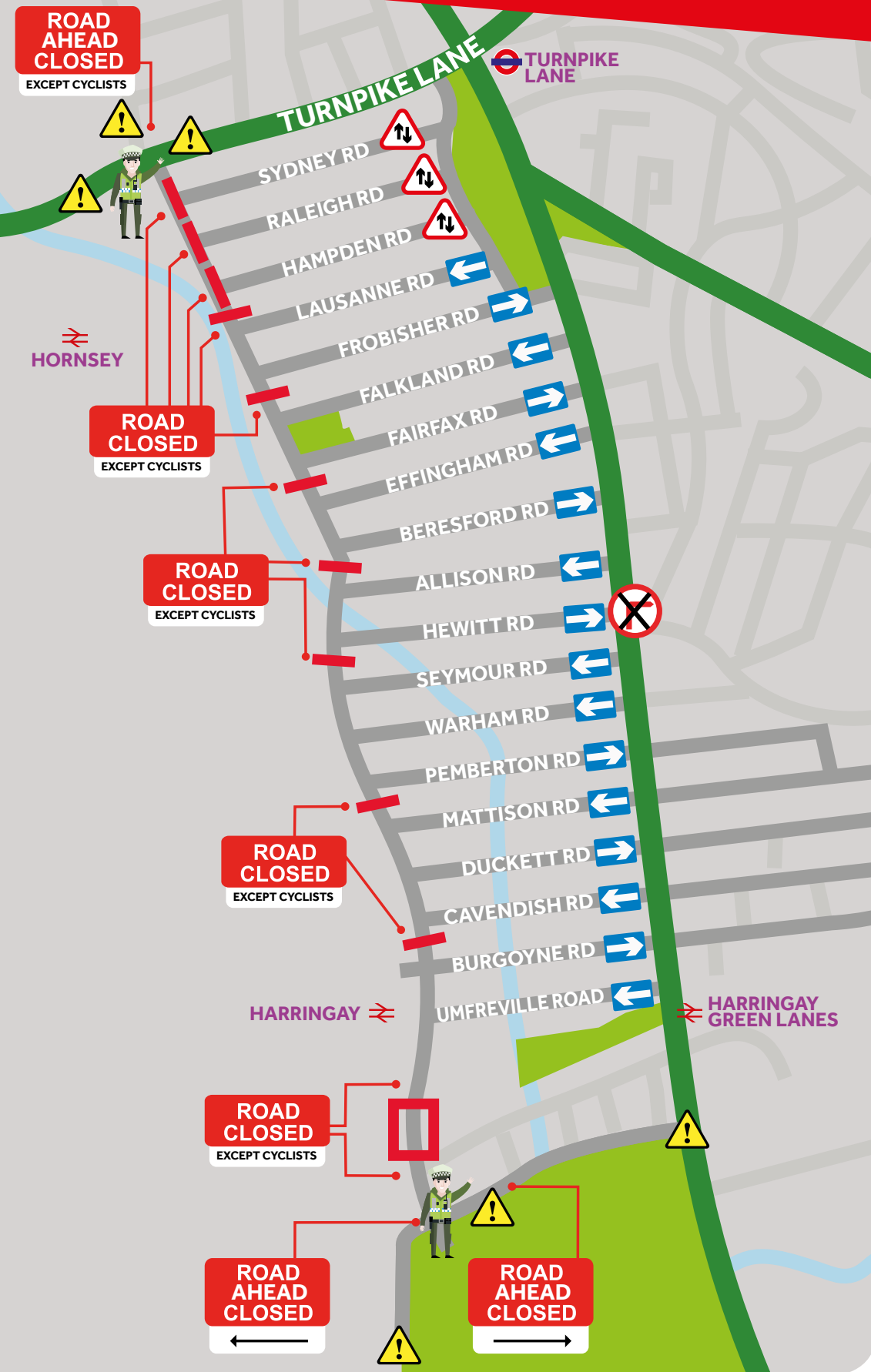

These roads will be made temporarily two way



Road closure points, they will be cycle accessible



The right turn bans at Hewitt Road and Salisbury Road will be rescinded



Traffic Marshall Locations



Enclosed works Area



ADVANCE WARNING

**WIGHTMAN ROAD/ALROY ROAD
CLOSED AT RAIL BRIDGE**

FROM 29TH MARCH TO SEPTEMBER 2016

24hrs

**BRIDGE REPLACEMENT
FOR ENQUIRIES CONTACT NETWORK RAIL**

Advance Warning
Signs Locations