



#

21 July 2011

Statutory Notification

Shared Zebra Crossing on Priory Road N8

Dear Resident or Trader,

I am pleased to inform you that the Council has secured funding from Transport for London's Greenways programme for cycle and pedestrian accessibility improvements on Priory Road.

We propose to construct a shared use pedestrian/cycle zebra crossing on Priory Road with a central island. We also intend to convert the pavements on both the north and south sides of Priory Road to shared use. In addition, we propose 'building-out' the pavements and introducing 'no loading at any time' restrictions to make it easier and safer for pedestrians crossing Park Avenue North and Park Avenue South.

We further intend constructing raised entry tables at the entrances to Park Avenue North and Park Avenue South. The raised tables will reduce the speed of vehicular traffic at the junction and this, combined with pavement build-outs, will improve safety for all road users - particularly for pedestrians and cyclists. Other features planned for this busy crossing point include dropped kerbs for step-free access to pavements, non-intrusive signage, tactile paving, and paving to define clearly the shared use nature of the pavement.

Full details are set out in the plan overleaf. This notification letter marks the start of a consultation period during which we welcome your comments or representations. You can contact us using the attached Freepost comment card, by email to Frontline.consultation@haringey.gov.uk or by telephone to our Project Engineer Michael Demosthenous on 0208 489 1694. Alternatively you can write to us at the address above. In view of the summer holiday season we are allowing extra time for views and comments, so please can you ensure these reach us no later than 2nd September.

Yours faithfully

Joan Hancox
Head of Sustainable Transport

This product includes mapping data licensed from Ordnance Survey with the permission of HMSO © Crown Copyright LBH 2011. All rights reserved.
License number 100019199.



NOTES:
KEY:

- Proposed tactile paving
- Proposed corduroy paving
- Proposed block/shared use paving
- Proposed paving slabs
- Proposed anti-skid surfacing (black colour)
- Proposed red colour tactile
- Existing lamp column
- Proposed sign post
- Proposed dropped kerbs
- Existing double yellow line
- Proposed double yellow line with blips
- Proposed shared use paving slabs to be placed on entrance to shared area
- Proposed keep left bollard
- Existing tree
- Proposed tree

| Row | Description | Checked | Date |
|-----|-------------------|---------|------|
| | Greenways Link 04 | | |

Project: Greenways Link 04
Title: Priority Road / Park Avenue North
Proposed shared use zebra crossing

Drawn: MD
Checked: DG
Scale: A3@1:200
Date Drawing Created: 11/07/2011
DWG No: SS/II/10200
Rev: E

Frontline Services
Highways Asset Group
2nd Floor South, River Park Tower, 235 Rye Road, Rye, East Sussex, TN31 6LJ
Tel: 01323 350000 Fax: 01323 350001
www.frontline-services.com

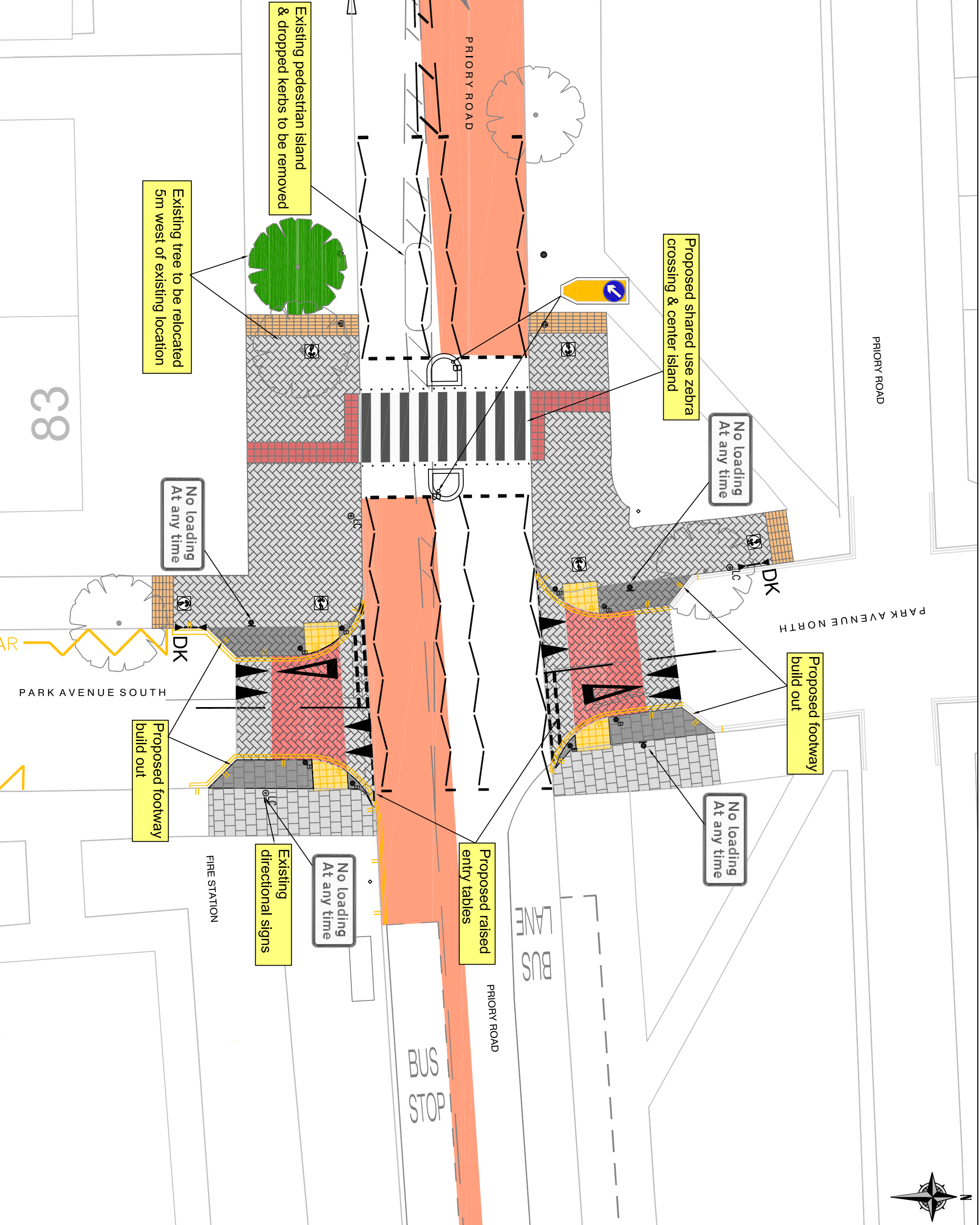

38