

# Leisure Services Newsletter

Broadwater Farm Community Centre

December 2011

## Issue 1

### What's in this issue

News Brief...

Going the Xtra Mile pays off for the Broadwater Farm Team

### Page 2

- Community Partnership, Consultation and Open Days
- Homes for Haringey update

### Page 3

- Back to Earth (B2E)

### Page 4

- Leisure Services Management

### Page 5

- Programme Development Update

## Broadwater Farm Community Centre News Brief...

The Centre is now in its 25<sup>th</sup> year, since its build following the Broadwater Farm riots of 1985. The Centre was built with the aim of enhancing community cohesion bringing the community and partners together whilst using the Centre as a hub of activity. This still remains a strong focus 25 years on.

## We're winners of Councils Xtra Mile Award...

**The team at Broadwater Farm Community Centre are going to have a very Merry Christmas this year after being nominated for the Councils Xtra Mile Award.**

The Centre's Operations team were recommended for the Council Xtra Mile Award scheme earlier this year. Based on their dedication, commitment and operational management of the Centre through extremely challenging times and events during August and September this year.

## Operations Manager

Juan Rangel calls taken on:  
020 8489 5315 or email:  
juan.rangel@haringey.gov.uk

## Assistant Manager

Augustine Yeboah calls taken on:  
020 8801 4115 or email:  
Augustine.yeboah@haringey.gov.uk

## Why Not book a wedding, birthday party or event at

Broadwater Farm Community Centre call us now: 020 8801 4115 or visit:  
www.haringey.gov.uk/broadwaterfarm

# Community Partnership, Consultation and Open Day

The Council have engaged and worked closely together with numerous community groups and organisations with the aim of capturing the needs of the local residents, a number of Open Days have also been organised with these organisations

- Residents Association
- Key User forum

- Ward Councillors
- Back to Earth
- Lordship Rec. User Forum
- BWF area/LRUF Stakeholders Group Meetings

Consultations / Open days have been very successful which has given the Community the opportunity to express their interests in the forward planning

and development of this facility. The forums/sessions will continue, they are advertised on the notice boards in the centre and should you wish to find out more information on these sessions, then do not hesitate to contact Augustine Yeboah 020 8801 4115

## Homes for Haringey

### First Floor Accommodation September 2011

In March 2011, Homes for Haringey approached the Council with a proposal to lease the whole of the first floor of Broadwater Farm.

The Council and in particular Leisure Services, undertook a review of activities that took place in this area.

The Council concluded that, to ensure the sustainability and viability of the centre, agreed for Homes for Haringey to lease the whole area at a very

competitive and commercial rate.

This process involved Consultation and Engagement with all the local communities and stakeholders, through the various community meetings and forums and at specifically organised Open Days.

Homes for Haringey moved in on the 1<sup>st</sup> September 2011 and the Centre is buzzing once again with people coming back into the Centre and therefore

raising its profile once again..

## Homes for Haringey

**Name** Angela Anderson

**Title:** Office Manager

**Offices for repairs, call centre and finance teams**

**Contact call centre free on 0800 195 3404**

# Back to Earth (B2E)

## With the Harmony Garden update

Back to Earth Projects is working in partnership with the local stakeholders to establish key B2E projects as part of a long term sustainable social enterprise.

This will promote healthy eating, local food growing, environmental education, green skills and catering and training.

B2E will train and employ local people, improving the quality of their lives.

Back to Earth have been a partner to the Centre for

approximately 4 years.

The Council has engaged with this organisation through a lease agreement which will commence in January 2012.

Back to Earth will be leasing the kitchen and office accommodation while also managing the Harmony Gardens programme which has been funded by the People's Millions.

Back to Earth have committing to operating a cafeteria 5 days per week Mondays – Fridays.

The majority of the food provisions used to prepare the meals/snacks etc will come from Harmony Gardens adjacent to the centre, managed by Back to Earth and tended by local residents and Volunteers.

**Football Coaching**

**Tuesday – Sunday  
16.30 – 21.00**

**With  
Clasford  
Stirling**

## Leisure Services Management July 2010

In July 2010, the Council's Leisure Services took on the day to day running of the Broad Water Farm Community Centre.

With the main purposes of improving the viability and community opportunities for the Centre together with:

- Establishing stronger compliance with Facility Management and Health and Safety requirements
- Implemented a Planned, Preventative and Maintenance approach to ensure the Centre is fit for purpose.
- Implemented the actions from the Councils Building Condition Survey from 2008 / 09 supplied by NPS
- Developed the outcomes from the Public Consultation 2009/10
- Development of Physical and Well being

activities for local residents

As stated, the centre will build on community engagement and emphasis community involvement in its future direction and use. The centre has been and will remain a facility for community events and private hire. There will still be a strong sport development link to provide a much needed focus for the young people of Broadwater Farm estate and surrounding areas.

The following, provides residents and stakeholders with an update on development of the Centre's various uses and activities.

## Centre Developments 2012

### Centre Developments 2012

As part of health and wellbeing provision, the centre will be redeveloping certain areas of the centre, these include:

- The current under utilised crèche will become a Health and Well being facility, to cater and assist with local Well Being organisations such as the local Health Centre, Guys and Goals – local health
- advise for men over 35 and Back to Earth healthy eating programmes
- The redevelopment of the far side of the Jazz Café into a multi purpose use area, extension of the Café and refurbishing of the kitchen.
- The redevelopment of the reception and admin office to a much more user friendly environment.
- The sports hall will have new dividers

to enable the centre to programme different activities at the same time. Also the line markings will be re marked.

These facilities are planned to be completed by April 2012.

**Why not book a Football birthday party**

**Available between Tuesday's and Sunday's 10.30-15.30**

**The 2D drawing of the ground floor Centre Developments at Broadwater Farm Community Centre can be viewed on the last page of this newsletter.**

- **But read on to the next page for information on Programme**

## Programme Development (Update)

Since Leisure Services took over the running of the centre a significant number of activities have been added to the programme including:

- Active Mondays - a number of Health and Wellbeing activities organised for women only throughout the day and evening
- A number of aerobic classes which are very well attended including two Chair Based exercises for our elder generation.
- the on going football development programme throughout the week from Tuesdays to Fridays from 4.30 to 9.00pm, aimed at boys and girls 5years to 16year olds
- table tennis sessions coached by 3E's, a registered Club Mark club for adults
- and juniors on Fridays from 5.30 to 7.30pm
- a number of specialised coaching work shops have been set up by various sport governing bodies such as Street Cricket, Netball Coaching coached by England players and much more.
- Holiday programme - the centre has successfully developed and implemented a number of holiday programmes, these are proving very popular with over 35 children attending per day at affordable prices.
- New for 2012 are Organised Birthday parties

<b>MONDAYS</b>	<b>Activity</b>	<b>Price</b>
09.15am – 10.45am	Think Fit Fun Female Fitness Class Followed by Health & Beauty Gossip Talk	Introductory Free Sessions
12.15pm – 1.15pm	Lunch Time Aerobics	Concessionary rate(contact centre for more details)
3.45pm – 4.30pm	Sports Hall Athletics For 6 – 10 year olds Come and have a go!	Concessionary rate(contact centre for more details)
5.30pm – 6.30pm	Zumba	
<b>TUESDAY'S</b>	<b>Activity</b>	<b>Price</b>
11.30am – 12 .30pm	Chair Based Exercise 55+ yr olds	Concessionary rate(contact centre for more details)
<b>THURSDAYS</b>	<b>Activity</b>	<b>Price</b>
11.00am – 12 noon	Body Conditioning	Concessionary rate(contact centre for more details)
<b>FRIDAY'S</b>	<b>Activity</b>	<b>Price</b>
5.30pm – 7.30pm	Junior/Adult table Tennis Coaching	Concessionary rate(contact centre for more details)

# SPORTS HALL

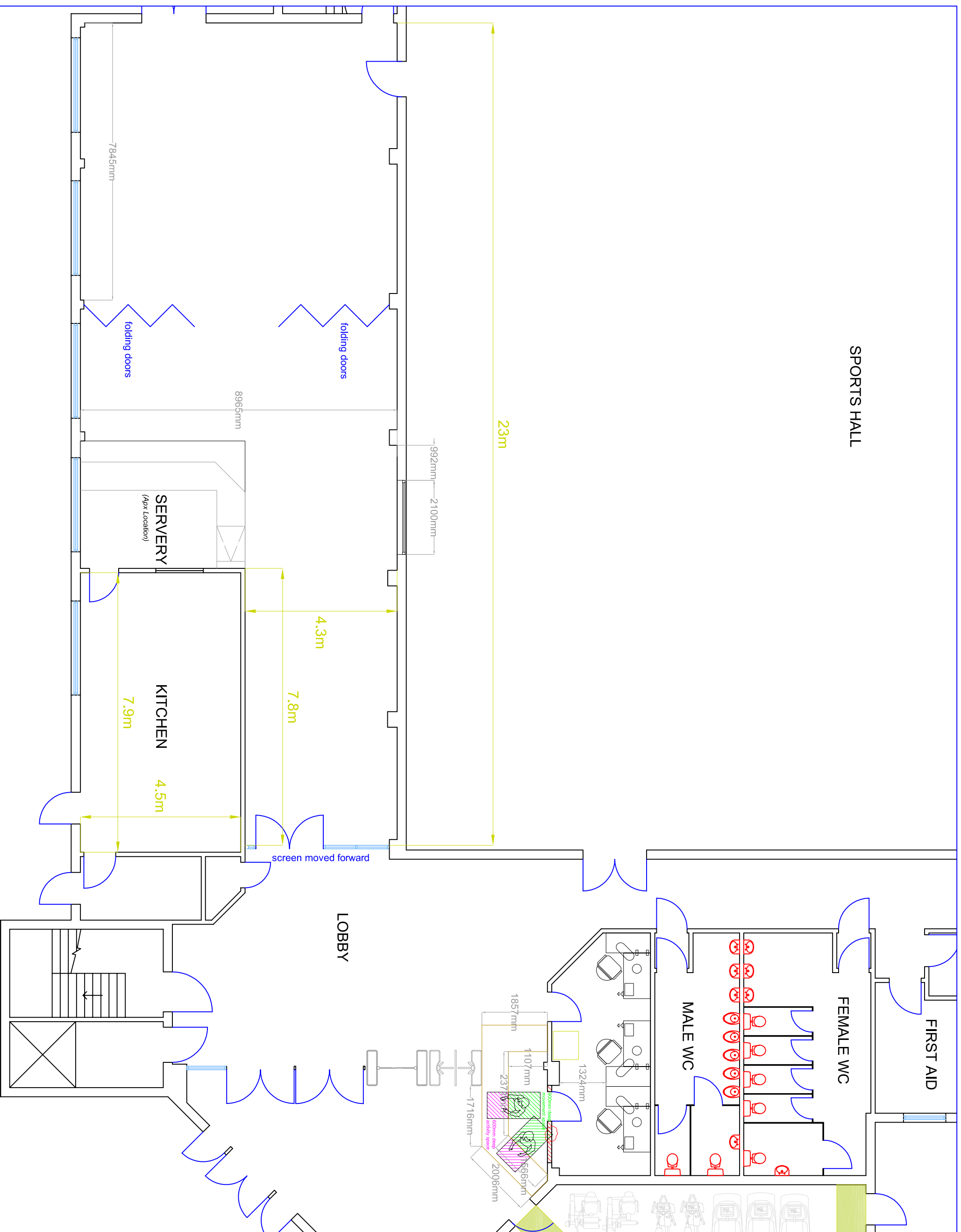

01	Servery & folding partitions rev	21/12/11	SIK	SIK
Rev	Revision Note	Date	Drawn	CHK

Client  
LBH

Project  
Broadwater Farm Community Centre

Site  
Broadwater Farm Community Centre  
Broadwater Farm Estate  
Adams Road  
Waltham  
N17 5HE

Drawing number	Revision	Scale
2312:10:05	Rev01	1:100 @ A3
Date	Dwn by	Ckd by
28/06/2011	SIK	PRC
		Plan Type
		DESIGN

Drawing Title  
Reception - Option B

Hamson Partnership, 114, The Square, Waltham, Northamptonshire, NN17 1JG. Registered in England, number 04522823. Limited liability company controlled by Hamson Partnership, a company controlled by Hamson Partnership, a company controlled by Hamson Partnership, a company controlled by Hamson Partnership. The contents of this drawing are the copyright of Hamson Partnership Limited.