



26 September 2011

## **WORKS NOTICE**

### **St Ann's Road N15: Improved Facilities for Pedestrians and Cyclists**

Dear Resident or Trader,

Further to our Statutory Notification letter of 21 July 2011, I am writing to inform you of the council's decision on the proposed pedestrian and cycle improvements for St Ann's Road N15.

We received some comments and one objection to the proposals set out in our notification letter. We have considered all feedback and the council's report is available on the website: [www.haringey.gov.uk/roadsafetyconsultations](http://www.haringey.gov.uk/roadsafetyconsultations).

I can now inform you that the Council has decided to proceed with the implementation of the pedestrian/cycle improvements on St Ann's Road; full details of which are set out on the plan overleaf.

The necessary work to put the measures in place is planned to start week commencing 03 October 2011 and will take approximately 8 weeks to complete. During this period there may be some disturbance to residents, schools and traffic to help ensure the work is carried out and completed safely. I would like to apologise in advance for any inconvenience caused.

Should you require any further information on the works, please contact Michael Demosthenous on 0208 489 1694 or e-mail: [Frontline.consultation@haringey.gov.uk](mailto:Frontline.consultation@haringey.gov.uk)

Yours faithfully,

**Joan Hancox**  
**Head of Sustainable Transport**

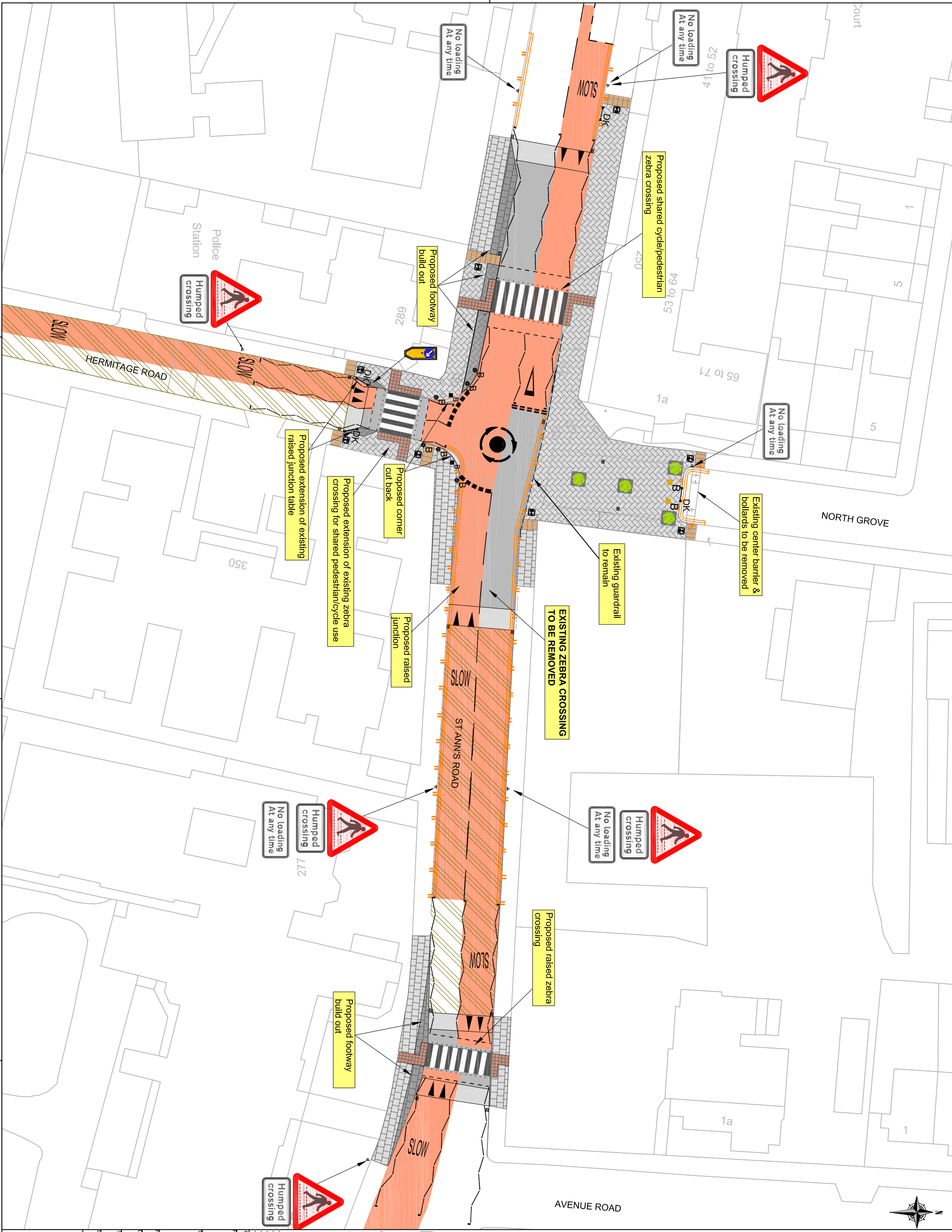

This product includes mapping data licensed from Ordnance Survey with the permission of HMSO © Crown Copyright LBH 2011. All rights reserved.  
License number 100019199.

NOTES:

KEY:

- Proposed corduroy paving
- Proposed block/shared use paving
- Proposed paving slabs
- Proposed carriageway resurface
- Proposed anti-skid surfacing (black colour)
- Proposed red colour tactile
- Proposed sign post
- Proposed dropped kerbs
- Existing guardrail to remain
- Proposed Doric bollard
- Proposed half bollard
- Proposed wooden bollard with shared use sign
- Proposed double yellow line with blips
- Existing single yellow line
- Proposed shared use paving slabs to be used on entrance to shared area
- Proposed 'Slow' road marking
- Proposed 'No loading at any time' sign
- Proposed humped crossing sign
- Proposed keep left bollard
- Proposed tree with tree pit

Rev	Description	Checked	Date

Project: Greenways Pedestrian / Cycle Improvements

Client: NTS

Scale: 1:500

Date: 14/09/2011

Drawn: MD

Checked: MD

Project Number: STH4400-002

Project Name: PLACE & SUSTAINABILITY TRANSPORT POLICY & PROJECTS

2017 Road Scheme: Final 1:500 Scale, 22/09/2017, 14/09/2011

Drawn: Place and Sustainability - L10 - 01/11/17